



# INSTRUCTION BULLETIN

No. 340468  
Machine: 800,810  
Published: 2-01/00  
System: SWEEPING

**NOTE: DO NOT DISCARD the Parts List from the Instruction Bulletin. Place the Parts List in the appropriate place in your machine manual for future reference. Retaining the Parts List will make it easier to reorder individual parts and will save you the cost of ordering an entire kit.**

*NOTE: Numbers in parenthesis ( ) are reference numbers for parts listed in Bill of Materials.*

Installation instructions for kit number 375400

## SYNOPSIS / PROBLEM:

This kit contains the parts needed to replace the right hand side brush cable on the model sweeper/scrubber.

Please follow step-by-step instructions.

## SPECIAL TOOLS / CONSIDERATIONS: NONE

(Estimated time to complete: 1 hour)

## PREPARATION:

(Refer to FIG. 1, 2 and 3)

1. Slowly drive the machine to a clean work area.

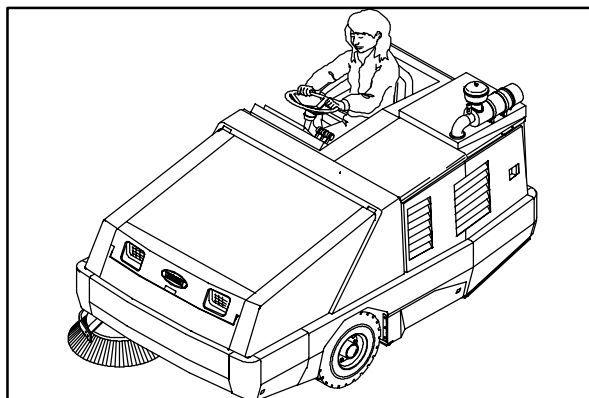

2. Pull and hold the hopper lift lever in the **Up** position and raise the hopper all the way up.

**FOR SAFETY: When using machine, make sure adequate clearance is available before raising hopper.**

*NOTE: Be aware that the minimum ceiling height needed to high dump the hopper is 3355 mm (11 ft.).*

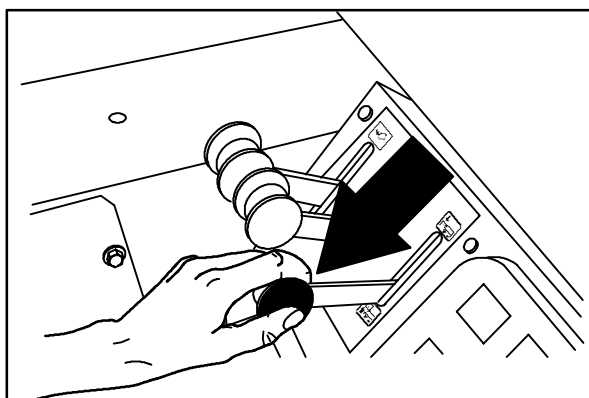

3. Remove the support bar from the storage clip.

**WARNING:** Raised hopper may fall. Engage hopper support bar.

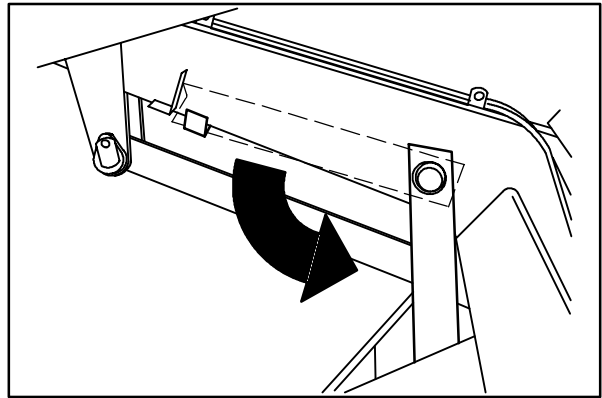

08589

4. Slowly lower the hopper so the support bar rests on the bar stop on the machine frame.

**WARNING:** Lift arm pinch point. Stay clear of hopper lift arms.

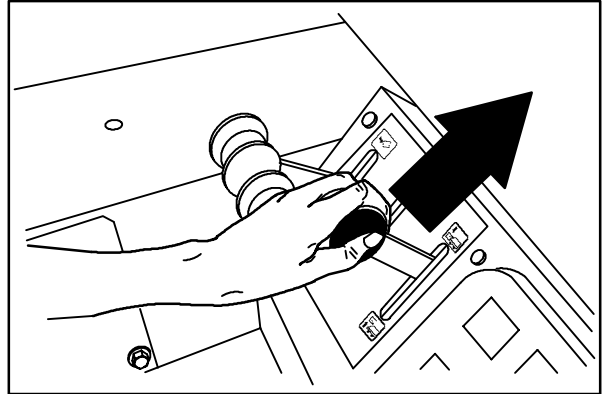

08482

5. Shut the engine off.

**FOR SAFETY:** Before leaving or servicing machine, stop on level surface and set parking brake. Then turn off machine and remove key.



## INSTALLATION: (Refer to FIG. 1 and 2)

1. Locate, disconnect and remove both ends of the old brush cable on the left hand side of the machine. Discard the old brush cable, set the mounting hardware aside.

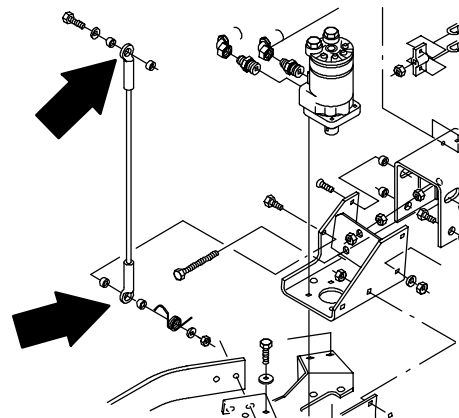

2. Mount the ball end of the new brush cable (1) to the motor mount bracket with the set aside hardware, cable hook (2), spacer (4) and new torsion spring (3). Secure with set aside hex screw, washer and hex nut. (Refer to FIG. 2 and 3)

**NOTE:** Check that the hook on the torsion spring is securely wrapped around the cable.

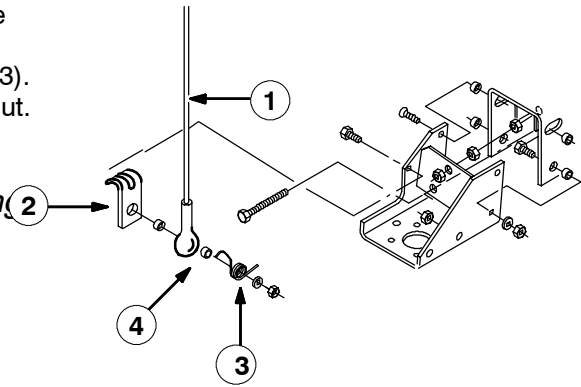

3. Mount the other end of the cable to the hopper lift arm with the set aside spacer, shoulder bolt (5) and washers (6). Recheck and secure all mounting hardware. (Refer to FIG. 2 and 3)

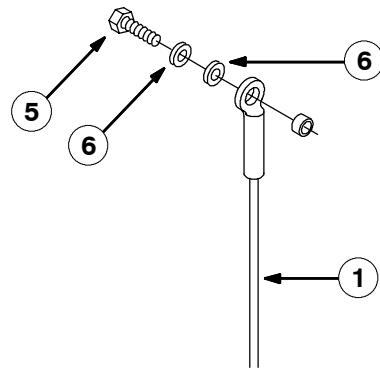

4. Start the engine.



5. Raise the hopper slightly to release the hopper support bar.

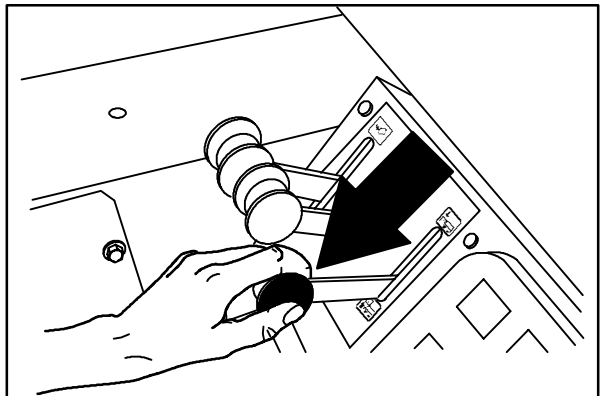

08480

6. Put the hopper support bar in the storage clip.

 **WARNING: Lift arm pinch point.**  
**Stay clear of hopper lift arms.**

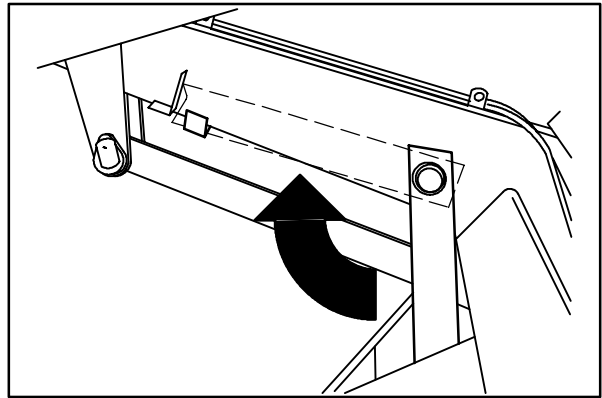

08590

7. Lower the hopper.

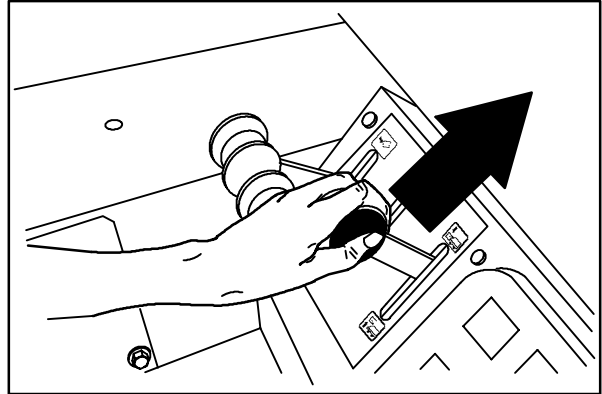

08482

8. Shut the engine off.



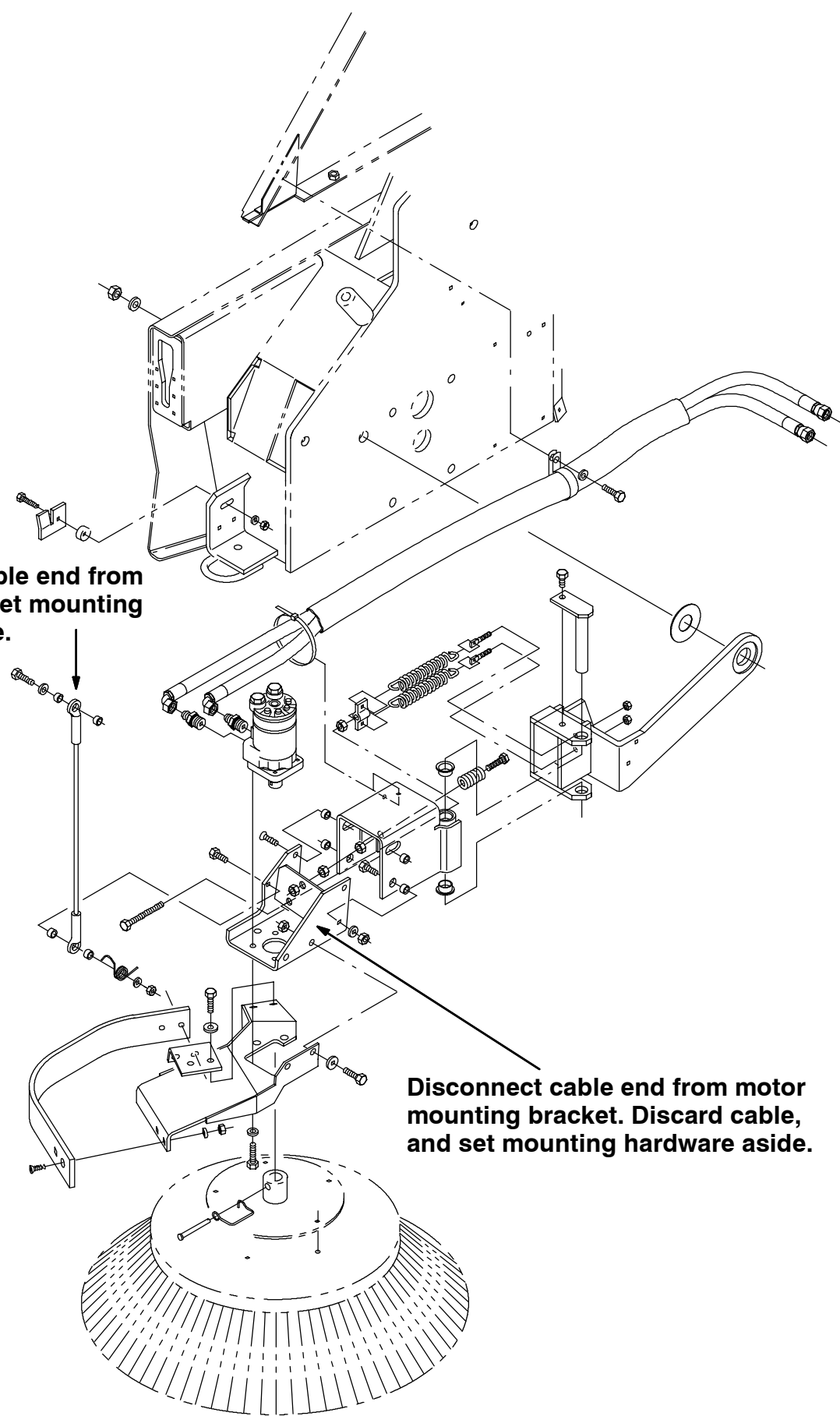

**Disconnect cable end from the machine. Set mounting hardware aside.**

**Disconnect cable end from motor mounting bracket. Discard cable, and set mounting hardware aside.**

**FIG. 1 - Side Brush Cable Removal, Right Side**

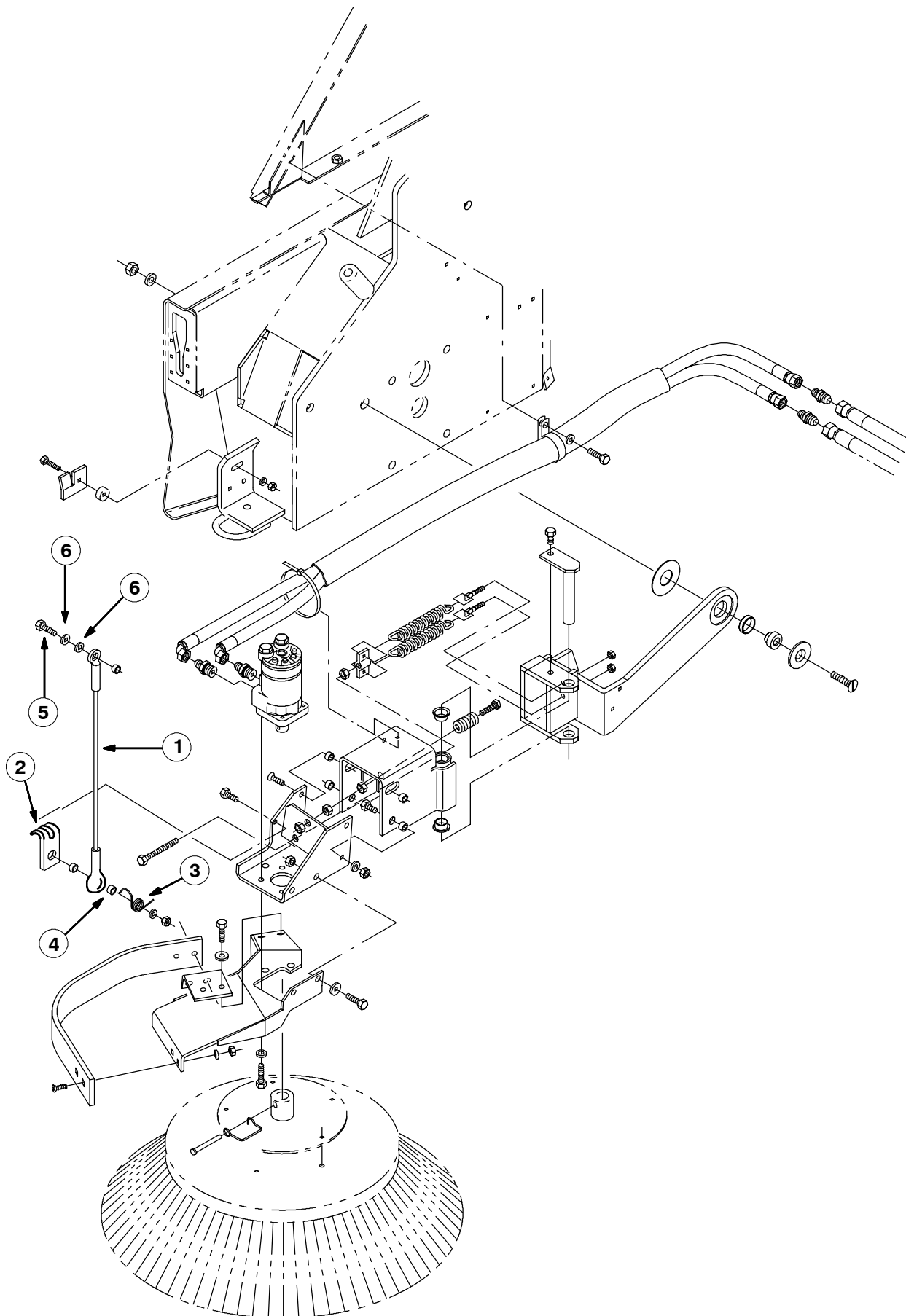

**FIG. 2 - Side Brush Cable Replacement Kit, Right Side**

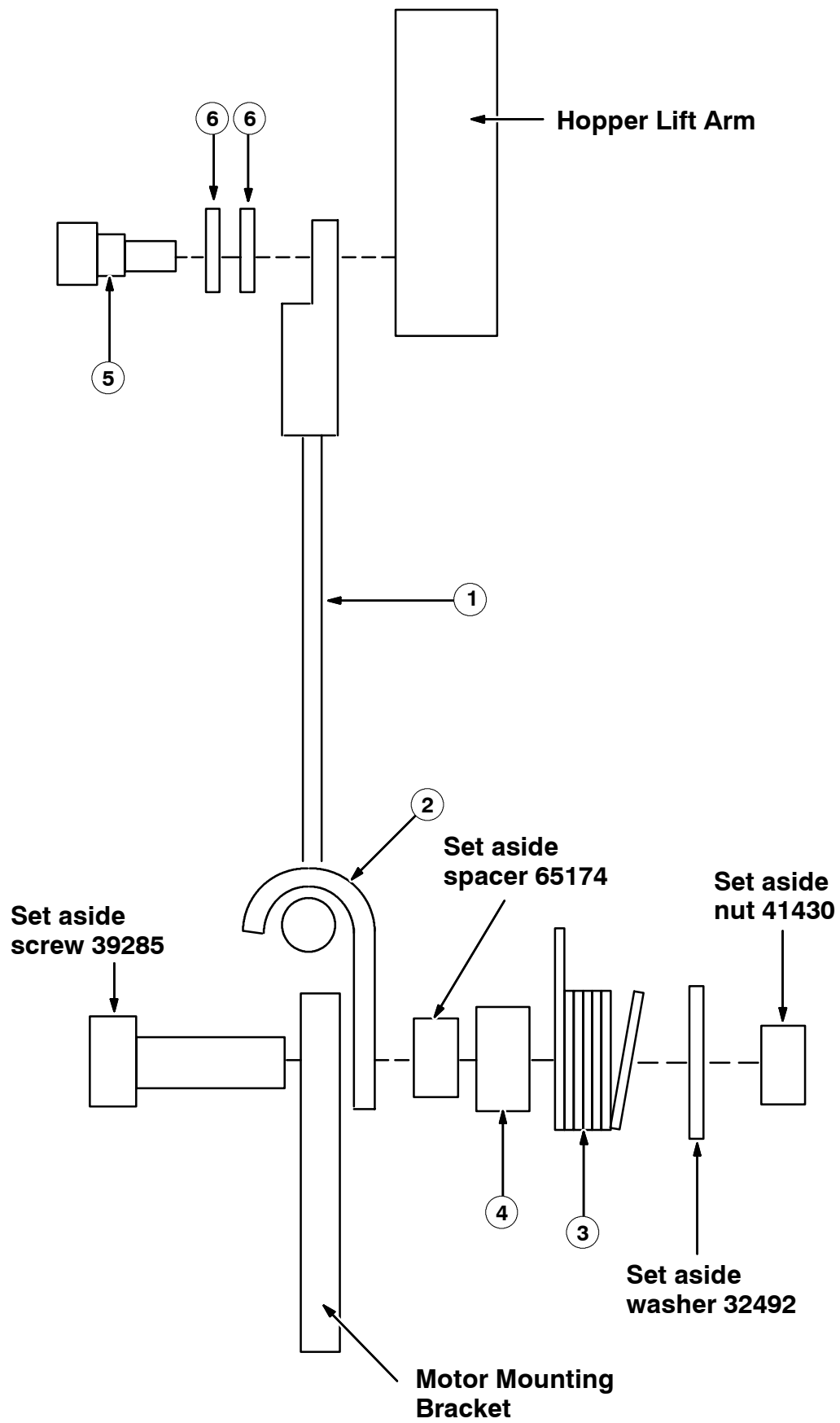

**FIG. 3 - Side Brush Cable Replacement Kit, Right Side**

**BILL OF MATERIALS FOR SIDE BRUSH REPLACEMENT KIT, RIGHT HAND 375400**

<b>Ref.</b>	<b>TENNANT Part No.</b>	<b>Description</b>	<b>Qty.</b>
1	375401	Cable, 0.25, 21.2L, 0.50eye / 0.44ball	1
2	375770	Hook, cable, 0.44D ball	1
3	375402	Spring, tors, 0.81ID 0.09wir 0.34coil	1
4	375404	Spacer	1
5	375405	Bolt, shld, 12MM X 12MM, M10 X 1.5	1
6	32486	Washer, flt, 0.50 sae	2

TENNANT COMPANY  
P. O. Box 1452  
Minneapolis, MN 55440-1452